



IT'S ALL ABOUT

YOU

The Cancer Center
at the Health Pavilion



Atlanta Medical Center

Your intown health care partnerSM





TODAY THE WAR AGAINST CANCER IS MORE WINNABLE THAN EVER BEFORE.

It's the word nobody wants to hear. Two short syllables that reach deep into our souls: cancer. Fortunately, today's cancer patients have more and more reasons to be optimistic, and dare to dream of a better tomorrow—thanks to Atlanta Medical Center's Cancer Center at the Health Pavilion.

The Cancer Center offers a special blend of education, screening, treatment and recovery—all in one warm, inviting building. Take a look and you'll find an experienced, highly trained staff, a caring atmosphere and some of the most effective and advanced treatments available.

A special blend of education, screening, treatment and recovery—all in one warm, inviting building.

This sophisticated facility was created, from top to bottom, with you in mind. The Center offers a myriad of comprehensive services and facilities. This guide will provide a quick overview on the wide range of resources available to you and your family.

Welcome to the Atlanta Medical Center's Cancer Center at the Health Pavilion.

1ST FLOOR

WHERE THE POWER OF MEDICINE
MEETS THE PASSION OF THE
HUMAN SPIRIT.

RADIATION ONCOLOGY
WELLNESS SERVICES (Mammography,
Bone Density and Ultrasound).
PATIENT EDUCATION RESOURCE ROOM
AND MEDIA CENTER

A. HAMBLIN LETTON AUDITORIUM
(150 seat Multipurpose Auditorium)

RADIATION ONCOLOGY

The Cancer Center offers radiation treatments from a Varian 2100c Linear Accelerator with the most advanced Intensity Modulated Radiation Therapy (IMRT) capability. This highly effective form of external radiation therapy uses photons to target the dose on some treatment sites more precisely than more traditional therapies. Also available are:

- **High Dose Rate Remote Afterloading (HDR)**—A high dose of radiation is delivered through an applicator for a few minutes and then removed. This may be repeated several times over a few days or weeks.
- **Low Dose Rate Implants (LDR)**—These implants are placed near or directly into the cancer. They deliver low doses of radiation and may be left in place for several days
- **Prostate implants**

In addition to malignancies, some benign conditions, like keloids and heterotrophic limbs, are treated here as well.

WELLNESS SERVICES

MAMMOGRAPHY

Mammography is a screening and diagnostic tool used for early detection of breast cancer.

ULTRASOUND

Ultrasound is an imaging method that uses high-frequency sound waves to look inside the breast. At Atlanta Medical Center, the ATL 5000 is the ultrasound machine of choice. This device excels at identifying cysts from solid masses. You are not exposed to radiation during this test.

BONE DENSITY

Your doctor may want you to undergo a bone density screening. The Cancer Center has a Lunar bone density assessment and screening tool that determines bone density at the hip and spine. This helps to detect the presence of osteoporosis in men and women with particular risk factors, such as radiation treatment and steroid use.



The Cancer Center's special blend of advanced medical technology and a highly personalized emphasis on the patient makes it both high tech and high touch.

PATIENT RESOURCE LIBRARY & MEDIA CENTER

At the Cancer Center, we encourage patients to become active participants in their medical care. To that end, we offer the free use of our extensive resource library and media center. The resource library is filled with valuable information you may find helpful during treatment planning and treatment itself. In addition, the Cancer Center also has several computers available for patients to use. Having access to the internet while waiting for an appointment may help you learn more about cancer and treatment options available to you. Or you can just surf the web.

2ND FLOOR

A SEAMLESS FUSION OF MEDICAL TECHNOLOGY AND HUMAN CARING.

FLEX CLINIC
INFUSION AREA
COMMUNITY ORGANIZATIONS
PHYSICIAN OFFICES

Atlanta Medical Center is committed to a multidisciplinary approach to treating cancer, providing individualized attention to fight the disease while also enhancing the quality of life for patients and their families.

FLEX CLINIC

The flex clinic has 12 exam rooms where participating physicians see patients. The clinic has three main purposes:

SCREENINGS

The Atlanta Medical Center offers free prostate, breast, and skin cancer screenings throughout the year. For information about upcoming Cancer Screenings call (404) 265-1030.

MULTIDISCIPLINARY CLINIC

The Multidisciplinary Clinic is where patients can be seen and evaluated by several specialists during one session. Through this process, a multidisciplinary treatment plan can be created immediately. A personal Navigator assists the patient every step of the way, so he or she won't have to face treatment planning alone. For more information, call (404) 265-1030. Appointments should be requested by your physician.

TIME SHARE OFFICE SPACE

This program allows physicians to have an office at Atlanta Medical Center without the overhead of paying for unoccupied days. This places an increased number of specialists at the Cancer Center, available to our patients.

INFUSION AREA

The infusion area is where patients receive chemotherapy and other types of infusions and injections. The infusion room is spacious and tranquil, with bright, cheery sunlight and a wonderful view from the terrace. The Outpatient Infusion Therapy Center provides a variety of services for patients and physicians. These include blood transfusions, chemotherapy, administration of intravenous fluids and other outpatient procedures. The unit has 10 reclining chairs and one observation room with a bed.

COMMUNITY ORGANIZATIONS

Atlanta Medical Center regularly teams with community-based organizations to run a wide range of programs designed especially for cancer patients. For example, Atlanta Medical Center and the American Cancer Society regularly offer "Look Good Feel Better," a monthly program where patients receive free cosmetic kits and learn about different ways to improve their appearances during treatment. You can get more information about this program and the American Cancer Society at www.cancer.org



3RD FLOOR

ADDITIONAL PHYSICIAN OFFICE SPACE

4TH FLOOR

HOPE IS HERE!

AMERICAN CANCER SOCIETY HOPE LODGE CONNECTION AT ATLANTA MEDICAL CENTER

The American Cancer Society is a nationwide, community-based health organization dedicated to eliminating cancer as a major health problem. The ACS focuses its efforts on prevention and diminishing suffering from cancer through research, education advocacy and service. Now, the American Cancer Society and Atlanta Medical Center have joined with the ACS to open the first Hope Lodge connection.



The Hope Lodge is a home-away-from-home for cancer patients and their caregivers. Featuring 12 beautiful suites, the Lodge provides a free, temporary home to non-local patients and their caregivers who are actively receiving treatment at Atlanta Medical Center. In addition, the facility also features private rooms for patients who wish to rest after or before treatment. The Hope Lodge is dedicated to providing an environment that encourages support, renewal and hope, both in body and spirit, for patients and their families. Physicians can request a referral form by calling (404) 265-0058.

TRANQUILITY SALON AND SPA

The Tranquility Salon and Spa is a special place for pampering and total pleasure. The full-service salon offers private rooms for patients undergoing cancer treatments. The salon is equipped with all the things you need to look and feel better. Enjoy a massage while you wait for an appointment or get your hair and nails done.

1ST FLOOR

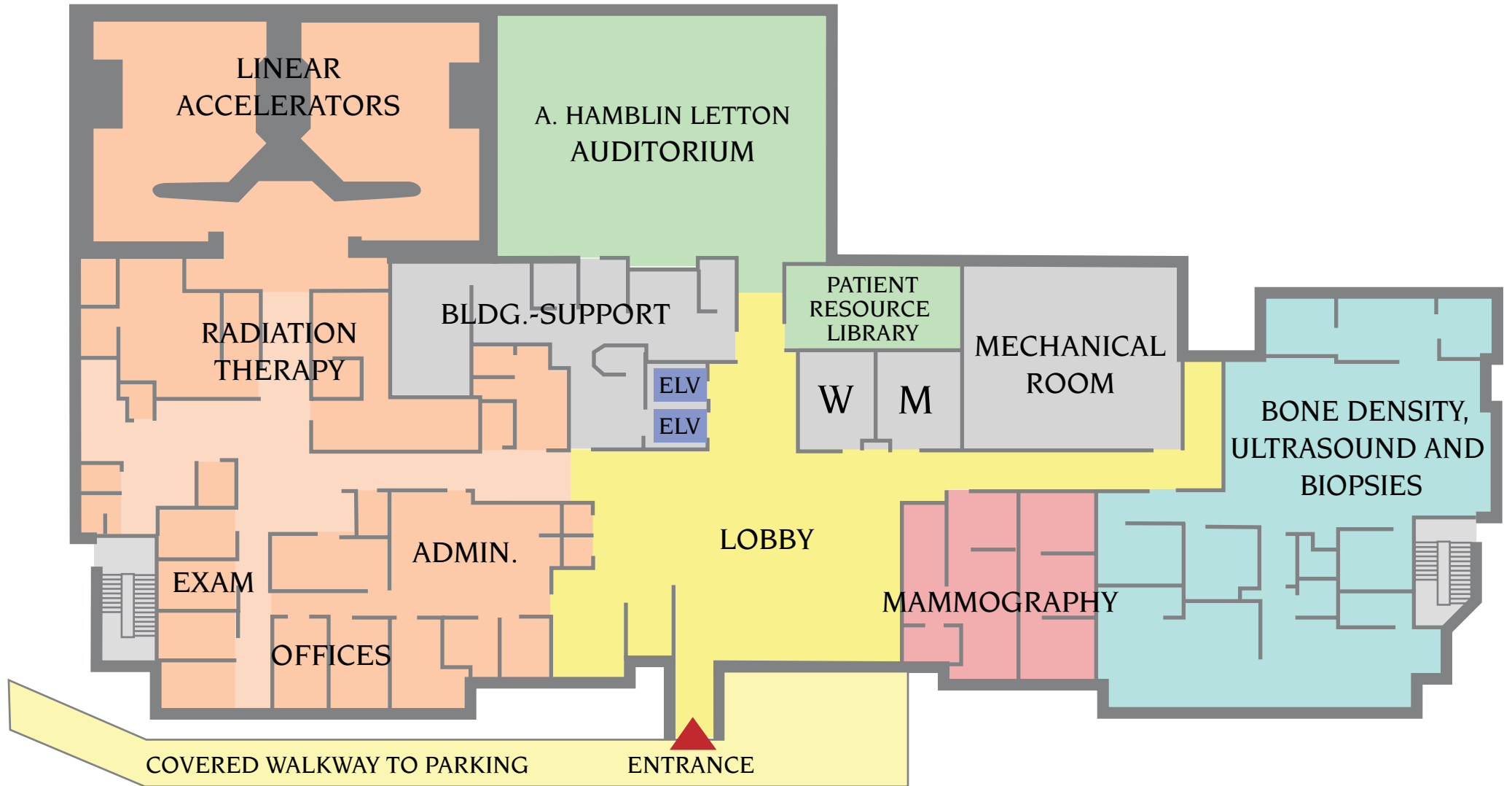

2ND FLOOR

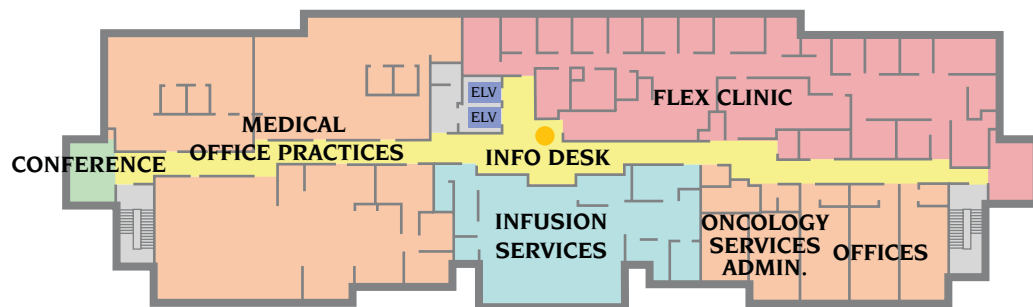

4TH FLOOR

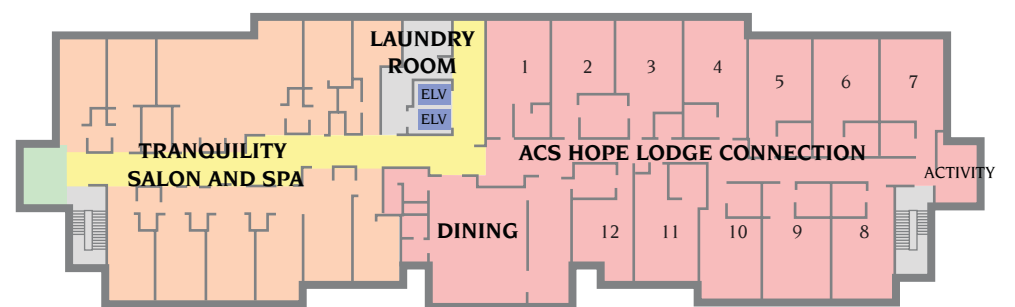

ADDITIONAL SERVICES

Available to Cancer Patients at Atlanta Medical Center

An uncompromising commitment to your health and well-being.

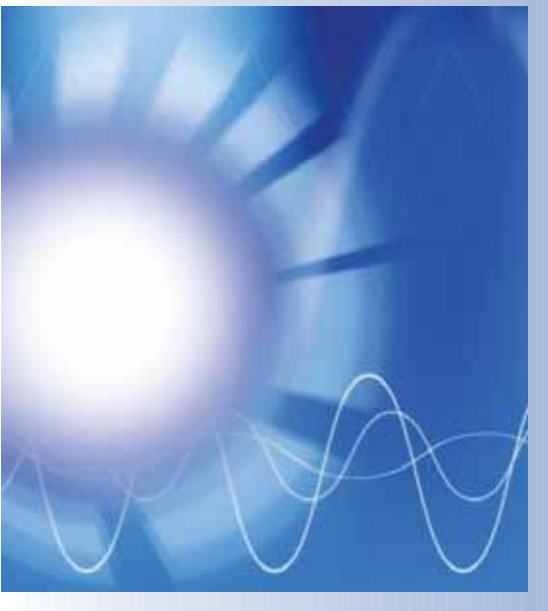

NUCLEAR MEDICINE

Atlanta Medical Center's Nuclear Medicine Department features physicians specifically licensed for diagnostic and therapeutic nuclear medicine procedures. These highly-trained professionals interpret the imaging study of each patient, consulting directly with the primary physician to determine the cause of a medical problem. Nuclear medicine tests are extremely sensitive to abnormalities of function. These tests can help identify early progression of disease before the problem is apparent through other diagnostic tests.

Imaging agents available to patients at Atlanta Cancer Center include:

- **OctreoScan** binds to hormone receptor sites on the surface of tumor cells. Researchers have produced antibodies that seek out and bind to certain cancers, including ovarian cancer and colon cancer.
- **ProstaScint** helps locate sites of prostate cancer and determines whether the cancer is confined to the prostate region or has spread to lymph nodes in the abdomen. This process can guide therapy directed at surgery or radiation to the prostate region, or to medical therapy sparing an unnecessary and non-beneficial surgery.

Early detection of lung cancer via a **Positron Emission Tomography (PET) Scan** holds promise for better treatment and outcome in the biggest cancer killer of men and women in Georgia: lung cancer. Every year, lung cancer kills more people in Georgia than breast cancer, prostate cancer, colon cancer and pancreatic cancer combined. The Georgia Institute for Lung Cancer Research includes nuclear medicine at Atlanta Medical Center and PET scanning as an integral part of its fight against this disease

Prevention and early detection are the keys to succeeding in the fight against cancer.

Nuclear medicine techniques also are used to evaluate lymphatic drainage of certain tumors, especially melanoma and breast tumors. These techniques may be performed to help surgeons more accurately identify the site of involved lymph nodes and allow more optimal surgical removal. The following techniques are offered by the Nuclear Medicine Department at Atlanta Cancer Center:

Sestamibi This technique has recently been shown to be an excellent method of localizing tumors of the breast, parathyroid glands, brain, lung,

or undifferentiated tumor and in discriminating between postoperative surgical scar and active or recurrent tumor sites.

Quadramet This process is now being used in conjunction with external beam radiation therapy and chemotherapy to provide significant relief of chronic bone pain that may accompany tumor spread. Relief of pain offers significant improvement in quality of life, which may be of great relief not only to the patient, but also to the patient's family.

MEDICAL SUPPORT SERVICES

The treatment of cancer often involves other, more wide-ranging aspects of a patient's health care. The comprehensive medical support services at Atlanta Medical Center are available to every cancer patient for treatment in all phases of the disease.

NUTRITIONAL SERVICES

Often, cancer patients are initially assessed by a nutritional specialist upon admission to the hospital, based on a variety of factors that may affect a patient's eating habits or nutritional needs. This assessment can be an important part of the overall treatment plan because nutrition support can improve or maintain a patient's dietary needs and enhance tolerance to certain therapies.

PHARMACY

Comprehensive pharmaceutical care is available to all oncology patients treated at Atlanta Medical Center. The drug, dose, route and interval are all reviewed for appropriateness based on each patient's weight, liver, and kidney function.

PAIN MANAGEMENT

Pain management is available to any Cancer Center patient in need. Each patient is evaluated by a nurse upon the start of treatment to determine whether further pain management is needed.





HEARING AID BANK

Patients who have had a hearing loss as a result of their disease or treatment may receive free hearing care services through the Cancer Center. A licensed audiologist is available to provide hearing evaluation, fit patients with hearing aids, and more.

ONCOLOGY SUPPORT SERVICES

Cancer is a disease that affects the entire family. Atlanta Cancer Center's multidisciplinary approach to treating cancer provides patients and their families with a broad range of support. We are concerned about each patient's quality of life and offer services that address these needs.

Pastoral Care is an important aspect of the care of the cancer patient. Chaplains assigned throughout Atlanta Medical Center's education program offer pastoral care to patients, their families and the staff of Atlanta Medical Center. Pastoral care is offered by personal visits in the hospital and at Atlanta Cancer Center and through various support groups.



Social Work ensure that patients receive comprehensive quality care, a social worker and case manager are assigned to work with cancer patients at Atlanta Cancer Center. This integrated team can provide counseling services, assess psychological profiles, help plan for financial responsibilities, coordinate care and assist with discharge planning for the patient.

Camp Bluebird is Atlanta Medical Center's cancer camp for adult cancer survivors. It is a community relationship with the BellSouth Pioneer Volunteers. The annual three-day camp gives participants an opportunity for sharing coping tips and support, learning about community resources and financial issues related to treatment, and providing a creative outlet through crafts. AMC staff members and specially- trained BellSouth Pioneer Volunteers serve as counselors at the camp. Speakers and presenters include AMC staff, physicians, cancer survivors, dieticians, and more.

Referrals available for services not provided at Atlanta Medical Center. Please see your treating physician.

PATIENT NAVIGATOR PROGRAM

The Atlanta Medical Center (AMC) has teamed up with the American Cancer Society (ACS) to bring the Patient Navigator program to oncology patients here at the hospital. This program provides cancer patients and their families with personalized coordination of resources to remove roadblocks to treatment and improve patients' quality of life. Consultation with the Patient Navigator will provide the support necessary for patients to keep appointments, follow treatment regimens, and gain access to available community-wide resources. Patient Navigator services often include assistance with:



- gas cards and transportation
- co-payments for prescriptions and office visits
- housing and shelter
- food and nutrition counseling
- home and utility expenses
- support groups and therapy
- caregiver support
- transitioning from hospital to home
- temporary lodging for treatment
- educational materials on cancer
- ACS programs and services
- someone to just listen

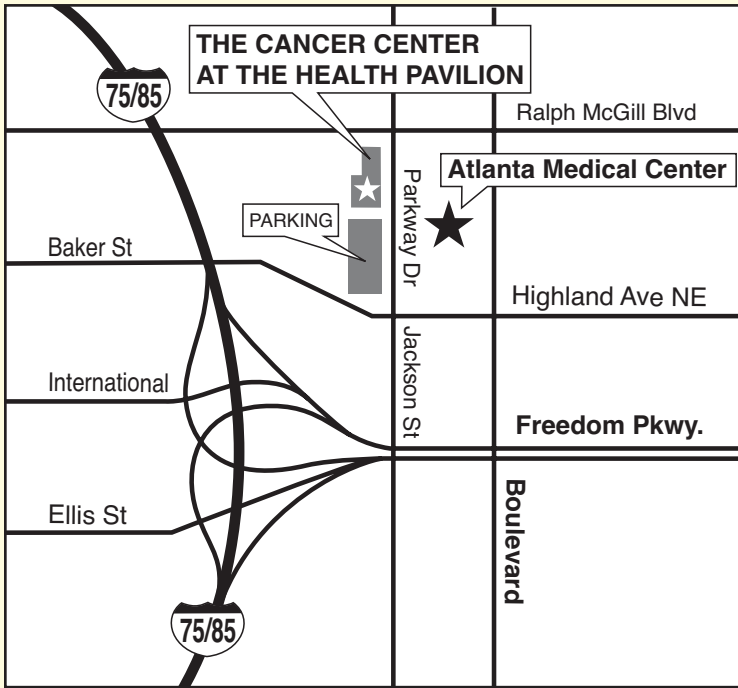

Atlanta Medical Center

Your intown health care partnerSM



320 Parkway Drive
404-265-1030
www.atlantamedcenter.com

For information on protocols offered at Atlanta Medical Center
please call 404 265-3592.

Protocol Websites:

Georgia Cancer Coalition -www.Georgiacancer.org
National Cancer Coalition-www.nationalcancercoalition.org
NCI-www.cancer.gov/clinicaltrials